

## FC Stack LC XX.30 440/600/1,000W

Fuel cell stack with scalable power output



- ⇒ scalable power up to 1,000 watts
- ⇒ ideal base component for individual system solutions
- ⇒ user-friendly stack, even without additional humidification
- ⇒ simple integration & high flexibility
- ⇒ tested design since 2015



	FC Stack LC 52.30	FC Stack LC 30.30	FC Stack LC 22.30
electr. power (nominal)	1,000 W	600 W	440 W
electr. voltage	26 - 52 V DC	15 - 30 V DC	11 - 22 V DC
electr. current (nominal)	37.5 A	37.5 A	37.5 A
number of cells	52	30	22
dimensions (LxWxH)	208 mm x 85 mm x 95 mm	147.5 mm x 85 mm x 95 mm	125 mm x 85 mm x 95 mm
weight (empty)	2.0 kg	1.7 kg	1.2 kg
media		hydrogen 3.0 (dry)	
oxidizing agent		ambient air (un)humidified	
H <sub>2</sub> inlet pressure		250 - 1,000 mbar	
operating temperature		60 - 75 °C (depending on the system design)	
article no.	40025	40024	40023

Other power output available on request.

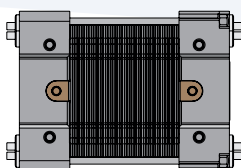

LC 22.30  
440 W  
22 cells

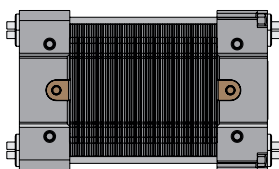

LC 30.30  
600 W  
30 cells

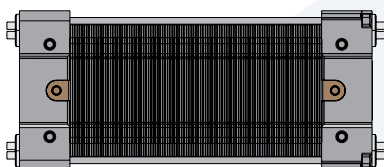

LC 52.30  
1,000 W  
52 cells

The PEM fuel cell stacks of the **FC Stack LC XX.30** series deliver up to 1,000 W of electrical power and can be operated with dry and humidified media. The liquid cooling enables direct utilization of the thermal power. The stacks are used in various applications, such as e-mobility, test environments, home energy technology and UPS applications. With the FC Stack LC xx.30 from balticFuelCells, system integrators receive a production-ready unit from a competent and reliable partner.

### Optionally with control unit and BOP components

balticFuelCells also offers optional equipment for FC Stacks LC xx.30. This includes all the necessary sensors and actuators, as well as an electronic control system for the entire system.



ECU – Electronic Control Unit

EPR300 – Electronic Pressure Regulator